

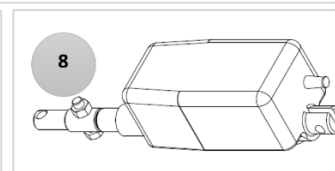

Assembling electrical kit 81995 to a Netti III

The kit consists of :

- Pos. 1 - 1 X Controlbox complete
- Pos. 2 - 1 X Remote control
- Pos. 3 - 1 X Charger
- Pos. 4 - 2 X Leg support - Actuator contact w/bracket
- Pos. 5 - 1 X Front tie bar complete
- Pos. 6 - 10 X Cable ties
- Pos. 7 - 1 X Actuator back
- Pos. 8 - 1 X Actuator tilt
- Pos. 9 - 2 X Lock nut M8
- Pos. 10 - 2 X Bended washer

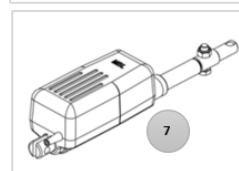
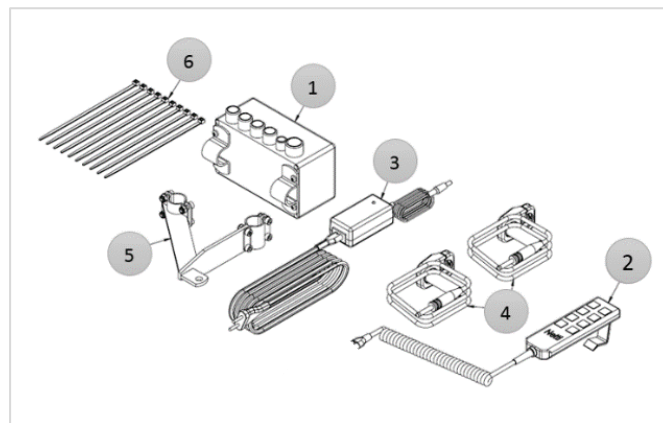

Pos. 9 and 10



Pos. 12 shows optional available actuator for leg support



NB: When electrical components are mounted to Netti III the wheelchair is TÜV approved as Netti III EI.

Check if all items are available before starting the work!

1. Remove the seat plate by disassembling the 4 screws and remove the gas cylinders for tilt and recline from chair. The cylinder hinge for tilt remains on the cross tube.

Remove the rear cross tube at seating frame by disassembling the bolts M8x40 Hex socket head on left and right side of the seating frame.

After put bolt M8x40 Hex socket head on left and right side of the seating frame back, add bended washer and fix the bolt with lock nut M8. Tighten the nuts with 14Nm when mounting

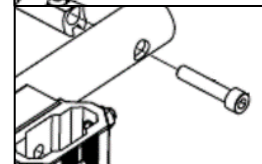
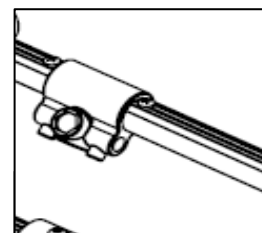
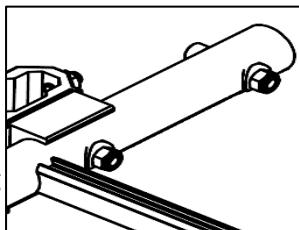
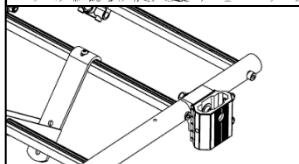
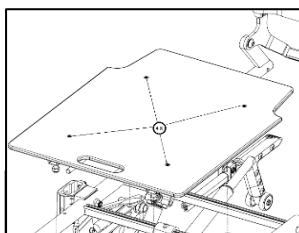

2021-09-MD0117UK

- Fix the Controlbox by using the clamps at the rear cross tube of the wheel frame.

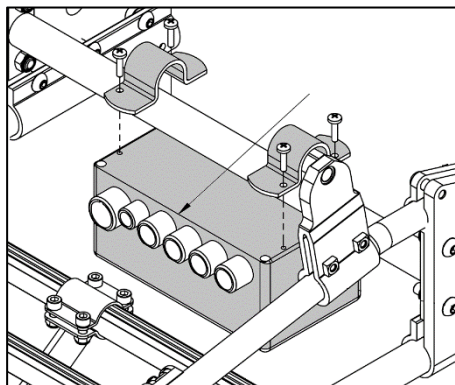
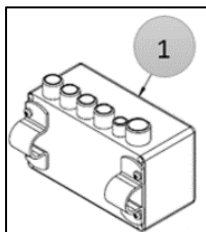

- Assemble the front tie bar for the tilt with the 8 bolts and nuts at the 2 front tubes of the wheel frame.

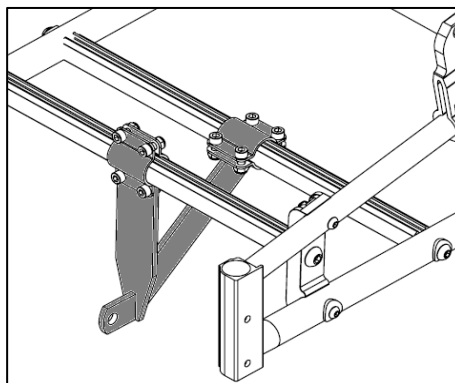
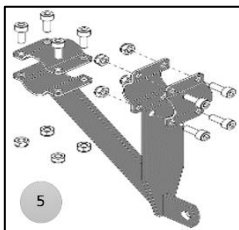

- Assemble the actuators to the frame as shown on pictures below. Tilt actuator:

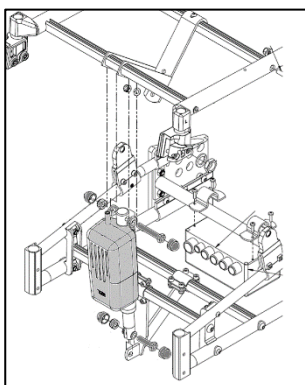

Recline actuator:

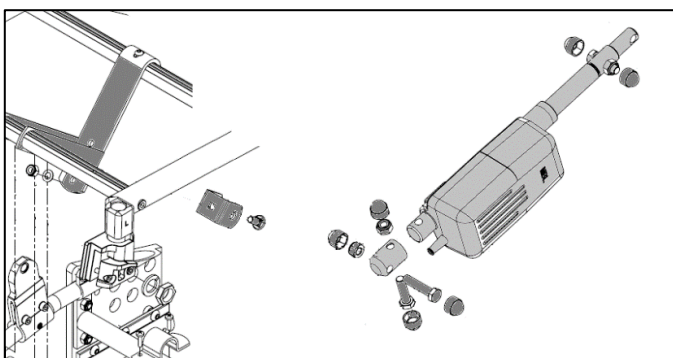

2021-09-MD0117UK

- Fix the actuator contact bracket for the leg support on each side of the front cross tube at seating frame.

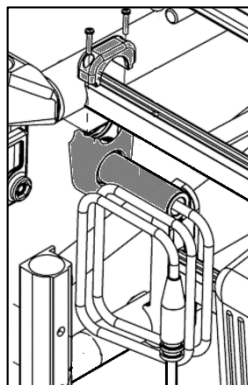
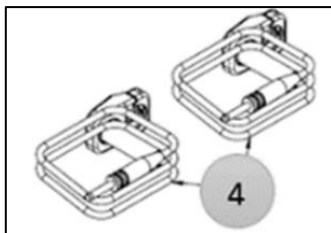

- Plug in the contacts to the Controlbox.

The different functions for the Controlbox is printed on the Controlbox label.



- The cables are to be tied in a way that no function is stuck and to prevent the cables to be stretched or damaged operating the Electrical kit.

Use 2 cable ties to collect loose hanging cables between the actuators.

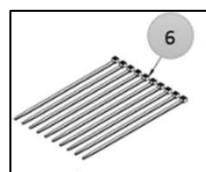

Use 2 cable ties on each side of seating frame front tube to fix the cables of the actuator contact bracket.



Use 2 cable ties on each side tube of the seating frame.



2021-09-MD0117UK

8. Connect the remote-control unit with the Control-box fixed to the wheelchair frame.

On the remote control the icons describing the different functions.

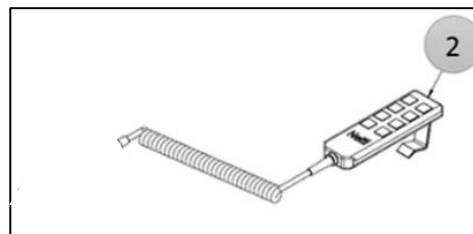

Battery LEDs, charging state

- 1 = Recline forwards
- 2 = Recline backwards
- 3 = Tilt forward
- 4 = Tilt back

- 5 = Left leg support up
- 6 = Left leg support down
- 7 = Right leg support up
- 8 = Right leg support down

- 9 = On-Off

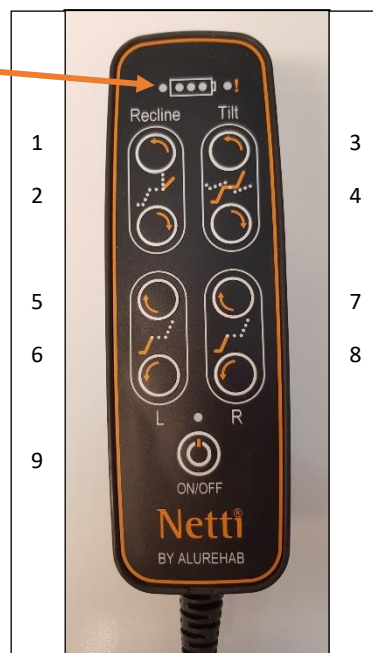

9. The seat plate can now be assembled back again.

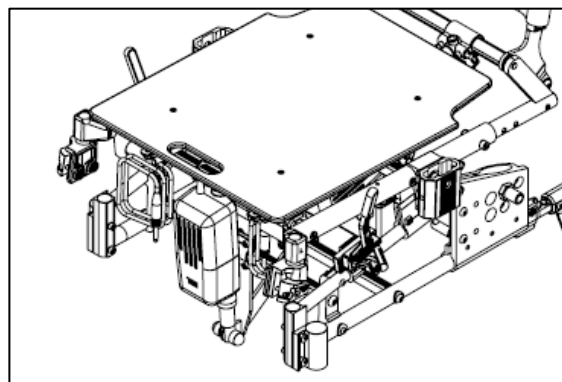

10. To mount the charging socket: Fix the socket with the bracket following, to the cross bar. Position it to the right side, as shown on the picture.
11. To charge the Electrical kit you need to connect the charger to the charger socket on the right side of the wheelchair frame. Replace the rubber plug in the charger socket when the charging is finished.



At the next pages you will find the User Manual for the Netti III Electric with additional information.

2021-09-MD0117UK

User Manual - Electrical components

The products are CE-Marked & follows EMC Standard EMC 60601-1-2.

Technical Specifications electrical actuators for Netti wheelchairs

Power: 100-240 V

Battery and Actuators: 2 x 12V, 20 Ah

Temperature: -20C - +50C

Service is to be carried out by distributor or qualified technician.

Warranty electrical components: 2 years for product related defects.

Warranty battery: 1 year when properly maintained.

MAINTENANCE

The battery should be recharged every day after use!

If the battery is not being used on a regular basis, it must be recharged at a minimum every 3 month. If the el. equipment is not used the last 2 weeks, they go into "deep sleep". Perform "**wake-up**" described on pg 8.

Maximum charge time: 24 Hours. When the green light is glowing, the battery is fully charged.

For mounting or replacing a battery, see following chapter

CLEANING

Actuators

The actuators are cleaned for dust and dirt according to need and should be optically checked for mechanical damage and breakage on a regular basis. The actuators should be wiped with a damp cloth.

Remote control

The remote control should be wiped with a damp cloth according to need.

Control box

The control box should be wiped with a damp cloth according to need, the sockets should only be wiped on the inside with a dry cloth.

Charger

The charger must be wiped with a dry cloth.

Weight

Control box: 1650 Gram

Tilt actuator: 1650 Gram

Recline actuator: 1610 Gram

Foot support actuator: 984 Gram (Pr. piece)

Hand control: 240 Gram

Cable for charger: 20 Gram

Total package: app. 7,1 kg



Control box



Actuator Leg support



Tilt actuator

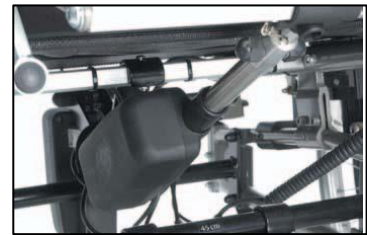

Recline actuator

2021-09-MD0117UK

This procedure includes the following:

- Installing/removing batteries into/from battery boxes
- Connecting battery cables

Warning/Notes

- Make sure POWER to the control box through charger IS OFF before performing this procedure.
- Before ANY actions, make sure all the jack plugs are disconnected - otherwise failure or damage of associated equipment may result.
- NEVER allow any of your tools and/or battery cables to contact BOTH battery terminals at the same time.
- An electrical short may occur and serious personal injury or damage may occur.
- We strongly recommend that battery installation and replacement ALWAYS be done by a qualified technician.
- The control box uses a sealed lead battery (CP1220) which must be recycled or disposed of properly.
- To remove the batteries from the battery box use T15 torx screwdriver (PZ, P).

The control box consists of:

(On the Netti Chair the box is mounted upside down compared with the illustration)

1. Upper cap (1pc)
3. Battery (3a,3b) (2pcs)
4. Separating plate (1pc)
5. Bottom cap (1pc)
6. Long wire with black covering (1pc)
7. Short wire with red or blue covering (1pc)
8. Long wire with red covering (1pc)
9. Fixation bolt (4pcs)

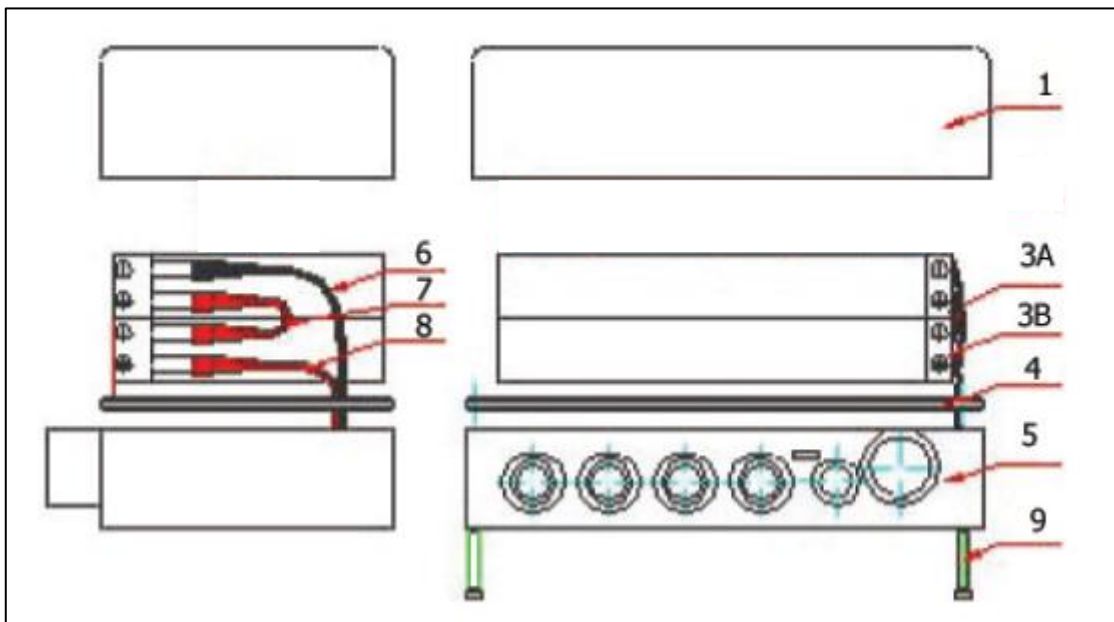

2021-09-MD0117UK

The battery removing procedure:

1. Clean the new battery terminals using a dry cloth
2. Place the control box on upper cap (upside down)
3. Unscrew four fixing bolts
4. Remove top cap
5. Pull out the battery cables from terminals
6. Take out the existing lead batteries from battery box
7. Clean the new battery terminals
8. Install the new batteries into the battery boxes.
Make sure that the terminals description on the batteries is facing the front side of control box.
9. Connect cables with terminals refer to battery cables connecting instruction. See below.
10. Cover the batteries with upper cup.
11. Replace fixing bolts with screwdriver.



The battery cables connecting procedure:

Connect battery cables to battery terminals as follows:

1. Negative (-) black battery cable (6) to negative (-) upper battery (3a) terminal
2. Positive (+) red battery cable (8) to positive (+) lower battery (3b) terminal
3. Remaining terminals (center) connect by using short red or blue cable (7)

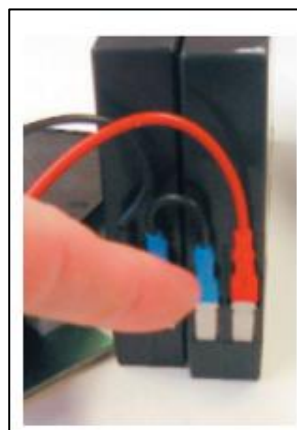
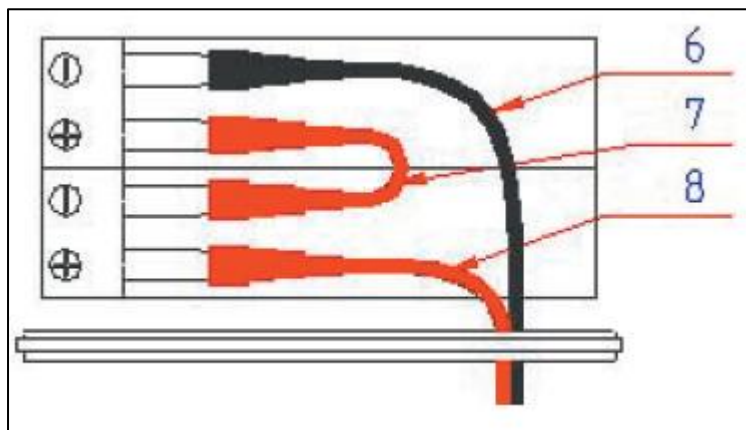

2021-09-MD0117UK

Troubleshooting for Netti electrical wheelchair

General: If an actuator is not responding when pressing the control panel:

- Check that all contacts to the actuator are securely in position.

NB: Due to IP classification the plugs have O-rings which gives a very tight fit in the control box. Press really firm to make sure the plugs are all-the-way into the sockets.

- It can be an advantage to have the control box set to charge. It will then increase its performance, if the case is that the control box is low on battery.
 - If a leg support is not working, pull out the plug from the control box, and try another outlet to see if it works.
 - If it now works something is either wrong with the outlet in the control box or the control panel. Try with a new control panel. You can also try using another actuator in the outlet for the leg support to confirm that the outlet is broken.
 - If it does not work, remove the leg support and pull out the plug for the leg support actuator from the contact bracket attached to the seat frame. Test it in another outlet directly in the control box, or in the contact bracket on the opposite side.
 - If it now works, the cable going from the control box to the contact bracket is defect, and should be replaced with a new one. If the actuator is not working in any other outlets, it is defect and should be returned to the supplier for replacement.

The same procedure is to be followed for all the actuators.

If the electrical equipment is not responding when pressing the control panel:

Symptom	Possible cause	Action to be taken
No engine sound or movement of piston rod	Actuator is not connected to control box The electrical system has gone into “deep sleep” to save energy Fuse in control box has blown Cable is damaged	Plug the actuator to another outlet in the control box, see explanation above. Wake up procedure: Plug in the charger. Turn on. Turn off. Remove the charger. Turn on - red light on hand-control is blinking while the battery status is checked. Battery status green lights go on. Ready to use / eventual charge. Change the fuse (contact dealer) Send actuator to dealer for repair
Engine is working but no movement of piston rod	Toothed wheel or spindle is damaged	Send actuator to dealer for repair
Engine sound but no movement of piston rod		Send actuator to dealer for repair
Actuator moves too slow or has low yield	Too low power supply	Recharge battery Send actuator to dealer for repair
Piston rod goes in but doesn't come out	Safety nut has become operative	Check by changing output socket. Send actuator to dealer for repair
Acoustic alarm, Battery status green LED give visible sign	Low battery voltage	Charge the batteries

2021-09-MD0117UK